

10号館 (教室棟)

1階

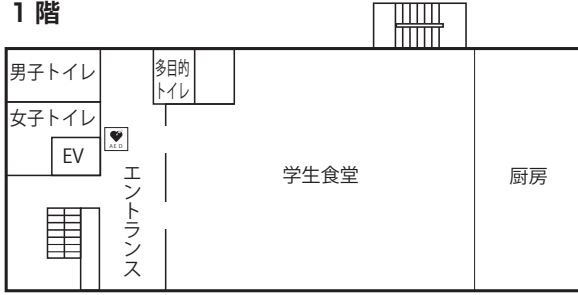

2階

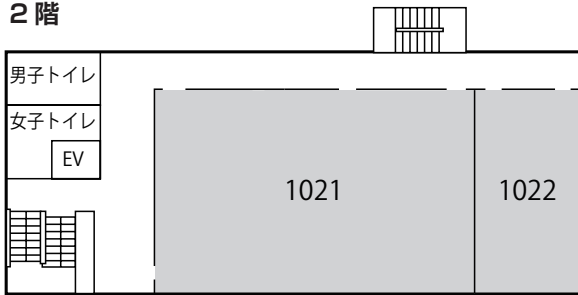

1021 210席 (140)

1022 60席 (40)

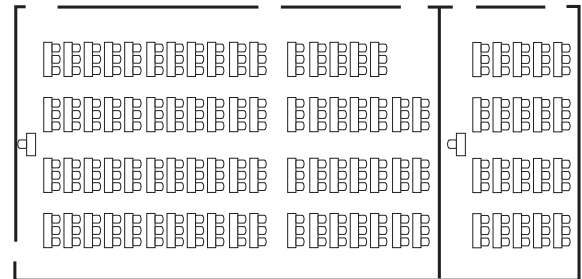

3階

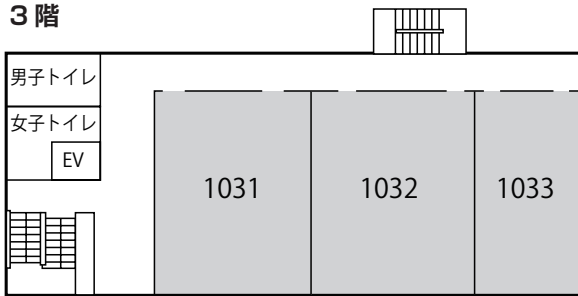

1031 108席 (72)

1032 108席 (72)

1033 60席 (40)

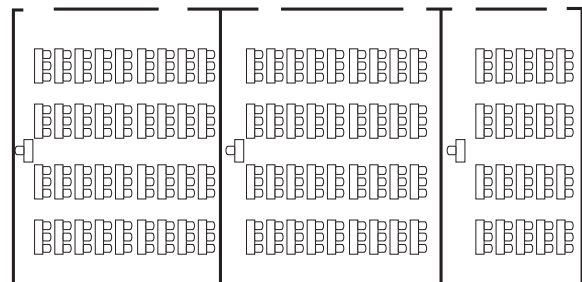

4階

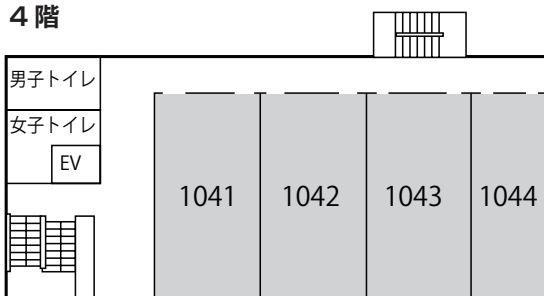

1041 60席 (40)

1042 60席 (40)

1043 60席 (40)

1044 36席 (18)

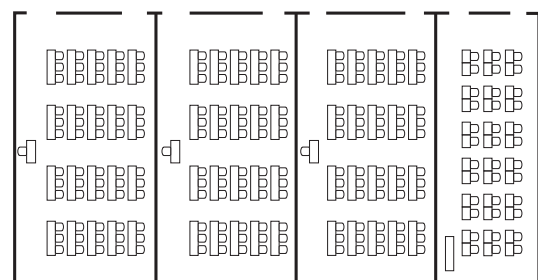

5階

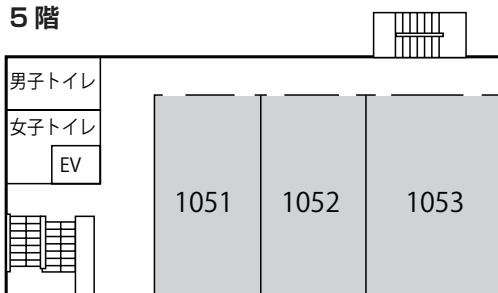

1051 60席 (40)

1052 60席 (40)

1053 84席 (56)

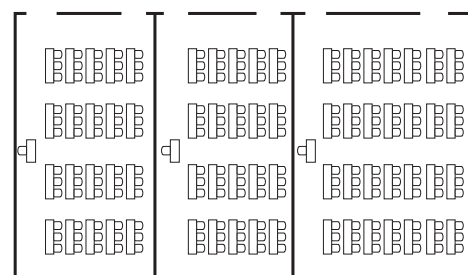

※ ()内は試験定員